

PRODUCT APPLICATIONS

The best wood fibre insulation for
roofs, walls and interiors







TABLE OF CONTENTS

Product Overview	S. 4
Ecological Wood Fibre Insulation for New and Refurbished Buildings – From Roof to Cellar Ceiling	S. 4
Applications and Solutions	S. 6
Roofs	S. 7
Walls	S. 8
Interior	S. 9
Technical Information	S. 10
GUTEX Multitplex-top	S. 10
GUTEX Ultratherm	S. 10
GUTEX Thermosafe-homogen	S. 11
GUTEX Thermofibre	S. 11
GUTEX Thermoflex	S. 12
GUTEX Thermoflat	S. 12
GUTEX Multitherm	S. 13
GUTEX Thermoinstal	S. 13
GUTEX Thermoroom	S. 14
GUTEX Thermosafe-wd	S. 14
GUTEX Thermosafe-nf	S. 15
GUTEX Thermofloor	S. 15
GUTEX Happy Step	S. 15
GUTEX Standard-n	S. 15
GUTEX Thermowall	S. 16
GUTEX Thermowall NF	S. 17
GUTEX Thermowall-gf	S. 17
GUTEX Thermowall-L	S. 18
GUTEX Thermowall Durio	S. 18

PRODUCT OVERVIEW

Ecological Wood Fibre Insulation for New and Refurbished Buildings – From Roof to Cellar Ceiling

GUTEX ecological insulation products are the ideal choice for a host of applications, including external thermal insulation composite systems, wall insulation for vented facades (rainscreens), insulation above rafters and/or between frame members with rain-tight sheathing, insulation of ceilings, interior insulation of exterior walls, insulation of service cavities, acoustic underlay in various floor assemblies and under many floor coverings. We source the raw material for our manufactured products from fir and spruce grown and harvested using solely sustainable forestry practices. The products conform to the highest quality standards and their KEYMARK certification mark confirms their compliance with all applicable EU standards.



GUTEX Multiplex-top
Certified rain-tight sarking board.



GUTEX Ultratherm
Unique rain-tight sarking board with patented tongue and groove interlocking system and an excellent U-factor.



GUTEX Multitherm
Moisture-resistant insulation board for rainscreen applications, supplemental above-rafter roof sarking or under-rafter insulation.



GUTEX Thermosafe-homogen
Universal wood fibre insulation board with excellent insulation properties for roofs and exterior walls.



GUTEX Thermofibre
Wood fibre blow-in insulation for enclosed cavities or as loose fill in unenclosed horizontal spaces.



GUTEX Thermoflex
Flexible wood fibre batt for use between rafters and cavities.



GUTEX Thermoflat
Compression-resistant wood fibre insulation board for flat roofs with wood, concrete or sheet metal construction.



GUTEX Thermoinstal
Compression-resistant insulation for service cavities.



GUTEX Thermoroom
Wood fibre insulation board for the interior insulation of exterior walls.



GUTEX Thermosafe-wd
Compression-resistant insulation for interior floors and walls.



GUTEX Thermosafe-nf
Impact insulation board with spruce joint strips for screw-fastened solid wood floor planking and short plank wood flooring.



GUTEX Thermofloor
Impact insulation board for all floor assemblies.

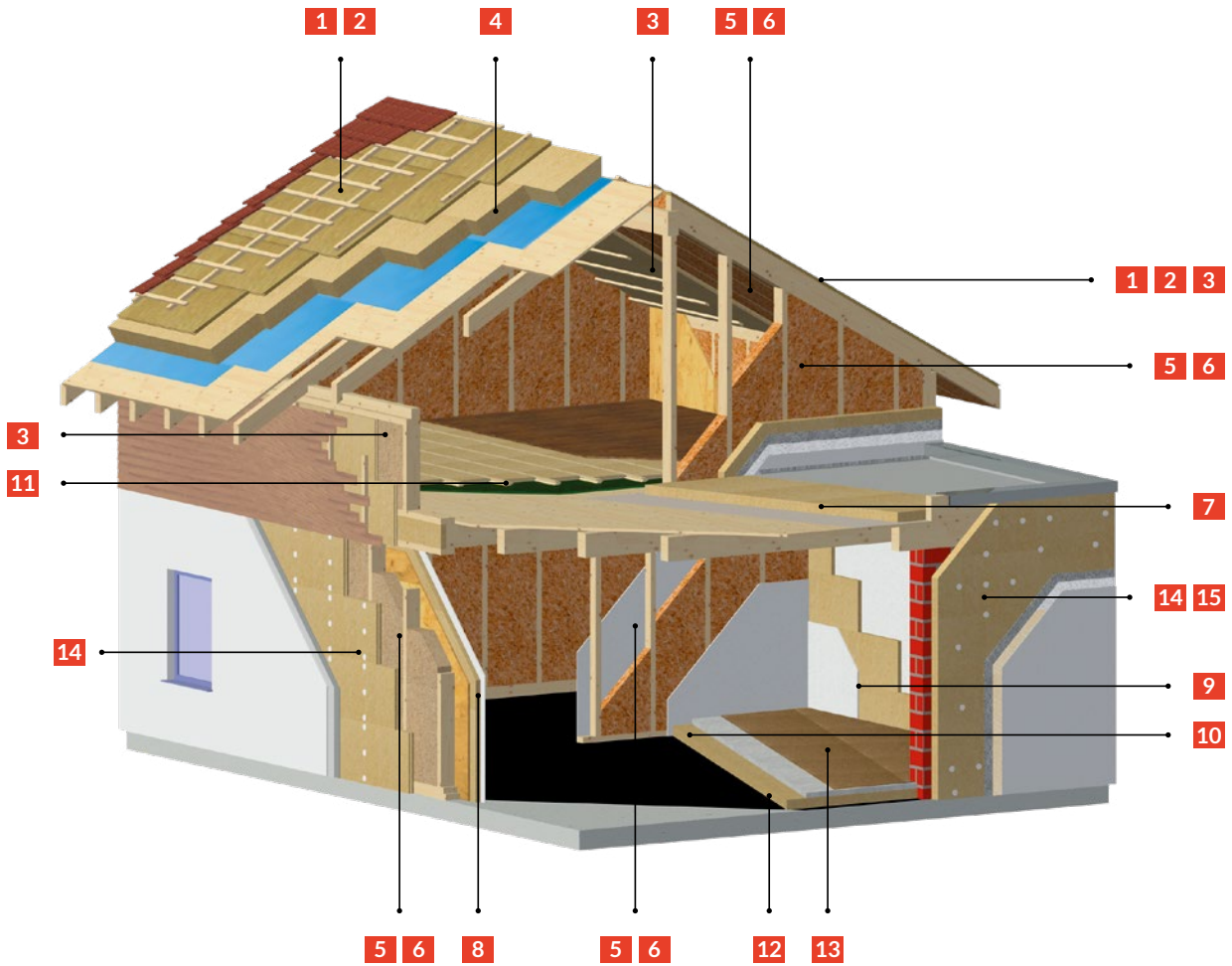

GUTEX Happy Step
Underlay softens the impact of footfall for more pleasant walking and quieter floors, such as wood planking.



GUTEX Thermowall/-gf /NF
Plasterboard for the ecological Thermowall ETICS.



GUTEX Thermowall-L
Lighter plasterboard delivers superb insulation with the ecological Thermowall ETICS. Particularly ideal for installation over uninterrupted masonry or wood substrates.



GUTEX Thermowall Durio
Specifically designed board for use in Durio facade systems finished in render and timber rainscreens.

NOTE

You'll find more information about properly using our insulation products at:

 www.gutex.de

APPLICATIONS AND SOLUTIONS

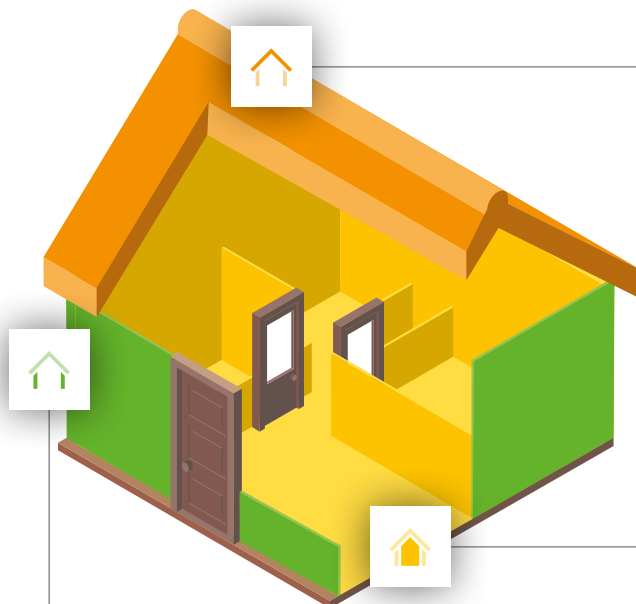

Roofs

- › **✓ Tecadio GUTEX roof refurbishment system**
- › Above-rafter insulation
- › Sarking boards
- › Flat roof insulation
- › Cavity insulation (GUTEX Thermoflex batts)
- › Cavity insulation (GUTEX Thermofibre blow-in insulation)

Interior

- › **✓ Intevio GUTEX interior insulation system**
- › Vapour permeable underlay installed from interior between rafters
- › Rafter underside insulation boards
- › Insulation under screed (dry / wet)
- › Top storey ceiling
- › Suspended ceiling
- › Solid wood flooring / Solid wood plank flooring
- › Service cavity insulation course
- › Partition walls
- › Cavity insulation (GUTEX Thermoflex batts)
- › Cavity insulation (GUTEX Thermofibre blow-in insulation)

Exterior Walls

- › **✓ Thermowall ETICS external thermal insulation composite system**
- › Render
- › Rainscreen
- › Brick facing
- › **✓ Durio system for unique facade design**
- › **✓ Implio window integration system**
- › Cavity insulation (GUTEX Thermoflex batts)
- › Cavity insulation (GUTEX Thermofibre blow-in insulation)

ROOFS

Protection against heat, cold and dependable resistance against rain

With GUTEX insulation products, your house or building stands secure against the elements. Our sarking boards are not just rain-tight, but as per TÜV Rheinland, they're hail-safe. And our insulation products deliver dependable protection against cold and excellent insulation against heat thanks to their lower thermal conductivity and greater volumetric thermal capacity. Significant diffusion openness, moisture absorption and release capacities ensure built structures and materials remain sound and healthy. High compression resistance and superb bend (flexural) strength mean the insulation products are stronger and more resistant to impact, making them more durable in the hands of contractors. Moreover, the durability and consistent dimensional trueness speed up their installation. Nail tape or strip sealant products are not required to seal temporarily exposed roofs. Such roofs remain weatherproof for up to twelve weeks.



GUTEX Multiplex-top



GUTEX Ultratherm



GUTEX Thermofibre

ADVANTAGES

- › Sarking and sheathing boards with patented tongue and groove joints deliver dependable protection against rain and superb durability
- › TÜV-certified hail protection (Hagelschutzklasse HW5)
- › Cross-brand cooperation between system designers, e.g. manufacturers of membranes, vapour barriers and adhesives
- › Seminars for system knowledge transfer

Systems and Products

- ›  **Tecadio GUTEX roof refurbishment system**
- › GUTEX Ultratherm rain-tight sarking board
- › GUTEX Multiplex-top rain-tight sarking board
- › GUTEX Thermosafe-homogen universal insulating board with homogenous cross-section
- › GUTEX Multitherm moisture-resistant insulation board
- › GUTEX Thermoflex flexible wood fibre insulation batt
- › GUTEX Thermofibre blow-in insulation

WALLS

Energy efficiency, comfort, wholesome living

Building with GUTEX systems and products to insulate exterior walls allows you to build compliant with energy efficiency standards, such as those stipulated by the KfW ("Effizienzhaus") in Germany, that may qualify you for rebates, preferred mortgage rates, etc. In addition, you have the assurance that your home will be comfortable and healthy. GUTEX Thermowall is the ETICS product for wood and masonry structures, while Durio provides you with the greatest design freedom. Implio gives you the assurance that your windows integrate tightly and effectively in your building's ETICS. And you may like to know that our wood fibre insulation boards are highly suitable in rainscreens installed on masonry, solid wood or timber-framed structures.



ADVANTAGES

- › Thermowall ETICS' certification offers you the freedom of choosing render systems from different manufacturers
- › ETICS installs directly to timber framing
- › Very diffusion-open insulation, which provides long-lasting integrity and performance
- › Cross-brand cooperation between system partners, e.g. manufacturers of render
- › Greater transparency and dependability in planning and installation thanks to the available 340 certified wood construction designs

Systems and Products

- › **Thermowall ETICS**
external thermal insulation composite system
- › **Durio system for unique facade design**
- › **Implio window integration system**
- › GUTEX Multitherm moisture-resistant insulation board
- › GUTEX Thermoflex flexible wood fibre insulation batt
- › GUTEX Thermofibre blow-in Insulation



GUTEX Thermoflex



GUTEX Thermofibre



GUTEX Thermowall/-gf



GUTEX Thermowall-L



GUTEX Thermowall Durio



🏠 INTERIOR

Improved thermal insulation, effective acoustic insulation and comfortable living spaces

Intevio interior insulation system installs easily and quickly, and provides dependable protection against mould and mildew. Thanks to lower costs and higher energy savings, the expense of refurbishment quickly pays for itself with this system. GUTEX insulation floorboards are suitable for use over concrete and in wooden joist ceiling constructions, as well as a host of different assemblies, delivering very good acoustic insulation, for example, under wet screed, mastic asphalt, particle or chipboard, OSB substrate floorboards, dry screed, engineered wood flooring, laminate flooring and solid wood planking. Application-specific solutions are also available for service cavities and light-weight partition walls.



ADVANTAGES

- › Moisture-resistant interior insulation
- › Highly effective insulation against impact and airborne noise
- › Many available certified and quantified acoustic insulation assemblies
- › Floor insulation with excellent impact resistance and good thermal conductivity performance

Systems and Products

- › **Intevio GUTEX interior insulation system**
- › GUTEX Thermosafe-homogen universal insulating board with homogenous cross-section
- › GUTEX Thermosafe-nf
- › GUTEX Thermosafe-wd compression-resistant insulation for interior floors and walls
- › GUTEX Happy Step, a universal underlay for high-quality interior floor coverings
- › GUTEX Thermoroom, specially designed to insulate interior sides of outer walls
- › GUTEX Thermoflex flexible wood fibre insulation batt
- › GUTEX Thermofibre blow-in insulation
- › GUTEX Thermoinstal compression-resistant insulation for service cavities
- › GUTEX Thermofloor versatile impact insulation board



GUTEX Multitherm



GUTEX Thermoroom



GUTEX Thermoflex



GUTEX Thermosafe-wd



GUTEX Thermoinstal

Product	GUTEX Multitplex-top			GUTEX Ultratherm				
Joint Type	Tongue and Groove			Tongue and Groove				
	DIN EN 13171			DIN EN 13171				
Thickness (mm)	22*	28*	35	50*	60	80	100	120
Length x width (mm)	2500x750			1780x600				
Weight per sheet (kg)	9.07	11.55	14.44	9.60	11.50	15.40	19.20	23.10
Weight per m ² (kg)	4.84	6.16	7.70	9.00	10.80	14.40	18.00	21.60
Boards per pallet	45	35	30	42	36	26	20	18
Square metres per pallet (m ²)	84.37	65.62	56.25	44.85	38.44	27.76	21.36	19.22
Actual coverage. length x width (mm)	2480x728		2480x722	1749 x 569 (1.00 m ²)				
Square metres per sheet (m ²)	1.87			1.06				
Weight per pallet (kg)	520	430	485	490	490	430	390	420
Density (kg/m ³)	~ 220			~ 180				
Nominal thermal resistivity R _D (m ² K/W)	0.50	0.60	0.75	1.15	1.40	1.90	2.35	2.85
sd-value (m)	0.07	0.08	0.11	0.15	0.18	0.24	0.30	0.36
Vapour diffusion factor μ	3			3				
Specific heat capacity (J/kgK)	2100			2100				
Nominal thermal conductivity λ _D (W/mK)	0.045			0.042				
Compressive stress/strength (kPa)	≥ 200			≥ 150				
Tensile strength perpendicular to board surface (kPa)	≥ 30			≥ 20				
Short-term water absorption (kg/m ²)	≤ 1			≤ 1				
Dynamic stiffness (MN/m ³)								
Compressibility (mm)								
Air flow resistivity (kPa·s/m ²)	≥ 100			≥ 100				
Fire reaction ¹⁾	E			E				

Legend is on page 19; * Product is not currently available. Please contact us for alternative options.

		GUTEX Thermosafe-homogen											GUTEX Thermofibre	
		Butt					Rebate						Unenclosed	Enclosed (cavities)
		DIN EN 13171											ETA-12/0181	
140	160	40	60	80	100	120	140	160	180	200	220	240	Bale length 330	
		1200x625											Bale dimensions 800x400	
26.90	30.80	3.30	5.00	6.60	8.30	9.90	11.60	13.20	14.90	16.5	18.20	19.80	15 kg (per bale)	
25.20	28.80	4.40	6.60	8.80	11.00	13.20	15.04	17.60	19.80	22.00	24.20	26.40		
14	12	112	70	56	42	36	32	28	24	22	20	18	18 bales (packages) per pallet	21 bales (packages) per pallet
14.95	12.81	84	52.5	42	31.5	27	24	21	18	16.5	15	13.5		
		1185x610												
		0.75												
390		430	380	390	340	380	420	420	420	410	410	410	290	330
		~ 110											25 - 30	29 - 50
3.30	3.80	1.00	1.50	2.05	2.55	3.05	3.55	4.10	4.60	5.10	5.60	6.15		
0.42	0.48	0.16	0.24	0.32	0.40	0.48	0.56	0.64	0.72	0.80	0.88	0.96		
		4											2	
		2100											2100	
		0.039											0.038	
		≥ 50												
		≥ 5												
		≤ 2												
		≥ 60											≥ 3	
		E											E	

Product	GUTEX Thermoflex												
Joint Type	Butt												
	DIN EN 13171												
Thickness (mm)	30	40	50	60	80	100	120	140	160	180	200	220	240
Length x width (mm)	1350x575												
Weight per sheet (kg)	1.20	1.60	1.90	2.30	3.10	3.90	4.70	5.40	6.20	7.00	7.80	8.50	9.30
Weight per m ² (kg)	1.50	2.00	2.50	3.00	4.00	5.00	6.00	7.00	8.00	9.00	10.00	11.00	12.00
Boards per pallet	144	112	90	80	60	48	40	32	30	24	24	20	20
Square metres per pallet (m ²)	111.78	86.94	69.86	62.10	46.57	37.26	31.05	24.84	23.28	18.63	18.63	15.52	15.52
Actual coverage, length x width (mm)													
Square metres per sheet (m ²)	0.77												
Weight per pallet (kg)	200												
Density (kg/m ³)	~ 50												
Nominal thermal resistivity R _D (m ² K/W)	0.80	1.10	1.35	1.65	2.20	2.75	3.30	3.85	4.40	5.00	5.55	6.10	6.65
sd-value (m)	0.06	0.08	0.10	0.12	0.16	0.20	0.24	0.28	0.32	0.36	0.40	0.44	0.48
Vapour diffusion factor μ	2												
Specific heat capacity (J/kgK)	2100												
Nominal thermal conductivity λ _D (W/mK)	0.036												
Compressive stress/strength (kPa)													
Tensile strength perpendicular to board surface (kPa)	≥ 1												
Short-term water absorption (kg/m ²)													
Dynamic stiffness (MN/m ³)													
Compressibility (mm)													
Air flow resistivity (kPa·s/m ²)	≥ 5												
Fire reaction ¹⁾	E												

Legend is on page 19; * Product is not currently available. Please contact us for alternative options.

GUTEX Thermoflat				GUTEX Multitherm										GUTEX Thermoinstal	
Rebate				Tongue and Groove										Butt	Butt
DIN EN 13171				DIN EN 13171										DIN EN 13171	
100*	120*	140*	160*	40	60	80	100	120	140	160	180	200	60	50	
1230x600				1760x600										3000x1250	1250x600
10.30	12.40	14.50	16.50	5.90	8.90	11.80	14.80	17.70	20.70	23.70	26.60	29.60	31.50	5.60	
14.00	16.80	19.60	22.40	5.60	8.40	11.02	14.00	16.80	19.06	22.40	25.20	28	8.40	7.50	
44	36	32	28	54	36	26	22	18	16	14	12	10	15	84	
32.47	26.56	23.61	20.66	57.02	38.01	27.45	23.23	19.00	16.89	14.78	12.67	10.56	56.25	63	
1215x585				1740x580											
0.73				1.05										3.75	0.75
490				350	330	350						320	520	520	
~ 140				~ 140										~ 150	
2.50	3.00	3.50	4.00	1.00	1.50	2.00	2.50	3.00	3.50	4.00	4.50	5.00	1.50	1.25	
0.30	0.36	0.42	0.48	0.16	0.24	0.32	0.40	0.48	0.56	0.64	0.72	0.80	0.24	0.15	
3				4										3	
2100				2100										2100	
0.040				0.040										0.040	
≥ 70				≥ 70										≥ 100	
≥ 7.5				≥ 7.5										≥ 10	
≤ 1				≤ 1											
≥ 100				≥ 100										≥ 100	
E				E										E	

Product	GUTEX Thermoroom						GUTEX Thermosafe-wd				
Joint Type	Butt						Butt				
	DIN EN 13171						DIN EN 13171				
Thickness (mm)	20	40	50	60	80	100	20	30	40	60	80
Length x width (mm)	1200x500						1250x600				
Weight per sheet (kg)	1.80	3.10	3.90	4.70	6.20	7.80	2.10	3.20	4.20	6.30	8.40
Weight per m ² (kg)	3.00	5.20	6.50	7.80	10.40	13.00	2.80	4.20	5.60	8.40	11.20
Boards per pallet	96	48	36	30	24	18	224	140	112	70	56
Square metres per pallet (m ²)	57.60	28.80	21.60	18.00	14.40	10.80	168	105	84	52.5	42
Actual coverage, length x width (mm)											
Square metres per sheet (m ²)	0.6						0.75				
Weight per pallet (kg)	200	140	170	180	170		600	520	510	460	490
Density (kg/m ³)	~ 150		~ 130				~ 140				
Nominal thermal resistivity R _D (m ² K/W)	0.50	1.00	1.25	1.50	2.05	2.55	0.50	0.75	1.00	1.50	2.00
sd-value (m)	0.06	0.12	0.15	0.18	0.24	0.3	0.06	0.09	0.12	0.18	0.24
Vapour diffusion factor μ	3						3				
Specific heat capacity (J/kgK)	2100						2100				
Nominal thermal conductivity λ _D (W/mK)	0.040	0.039					0.040				
Compressive stress/strength (kPa)	≥ 50						≥ 70				
Tensile strength perpendicular to board surface (kPa)	≥ 7.5										
Short-term water absorption (kg/m ²)											
Dynamic stiffness (MN/m ³)											
Compressibility (mm)							2				
Air flow resistivity (kPa·s/m ²)	≥ 100						≥ 100				
Fire reaction ¹⁾	E						E				

Legend is on page 19; * Product is not currently available. Please contact us for alternative options.



		GUTEX Thermosafe-nf	GUTEX Thermofloor		GUTEX Happy Step	GUTEX Standard-n				
		Tongue and Groove	Butt		Butt	Butt				
		DIN EN 13171	DIN EN 13171		DIN EN 13171	DIN EN 13171				
100	120	40	20	30	6	8	10	12	15	18
		1190x380	1200x600		860x590	2500 ² x1000				
10.50	12.06	2.35	2.30	3.45	0.80	5.00	6.30	7.50	9.40	11.30
14.00	16.80	5.20	3.20	4.80	1.60	2.00	2.50	3.00	3.80	4.50
42	36	75	180	120	640	130	100	80	70	55
31.5	27	33.91	129.6	86.4	324.73	325	250	200	175	137.5
		1170x360								
		0.45	0.72		0.50	2.50				
470	470	200	450		540	700				
		~ 130	~ 160		~ 260	~ 250				
2.50	3.00	1.00	0.50	0.75	0.10	0.15	0.2	0.25	0.3	0.35
0.30	0.36	0.12	0.10	0.15	0.03	0.04	0.05	0.06	0.08	0.09
		3	5		5	5				
		2100	2100		2100	2100				
		0.039	0.040		0.046	0.046				
					≥ 100	≥ 100				
					≤ 2.0	≤ 2.0				
		≤ 50	≤ 30							
		2	2							
		≥ 100	≥ 100		≥ 100	≥ 100				
		E	E		E	E				

Product	GUTEX Thermowall														
Joint Type	Butt														
	DIN EN 13171														
Thickness (mm)	20	40	60	80	100	120	140	160	80*	100*	120*	80	100	120	
Length x width (mm)	1250 x 590				830 x 600				2600 x 1250*			2800 x 1250			
Weight per sheet (kg)	2.40	4.70	7.10	9.40	8.00	9.60	11.20	12.70	41.60	52.00	62.40	44.80	56.00	67.20	
Weight per m ² (kg)	3.20	6.40	9.60	12.80	16.00	19.20	22.40	25.60	12.80	16.00	19.20	12.80	16.00	19.20	
Boards per pallet	224	112	70	56	42	32	28	24	12	9	8	12	9	8	
Square metres per pallet (m ²)	165.2	82.6	51.62	41.3	19.92	15.93	13.94	11.95	39.00	29.25	26.00	42.00	31.50	28.00	
Actual coverage, length x width (mm)															
Square metres per sheet (m ²)	0.73				0.49				3.25	3.25	3.25	3.5	3.5	3.5	
Weight per pallet (kg)	590	510	480	490	320	310	310	310	520	520	520	550	520	550	
Density (kg/m ³)	~ 160														
Nominal thermal resistivity R _D (m ² K/W)	0.50	1.00	1.50	2.00	2.50	3.00	3.50	4.00	2.00	2.50	3.00	2.00	2.50	3.00	
sd-value (m)	0.08	0.16	0.24	0.32	0.40	0.48	0.56	0.64	0.32	0.40	0.48	0.32	0.40	0.48	
Vapour diffusion factor μ	4														
Specific heat capacity (J/kgK)	2100														
Nominal thermal conductivity λ _D (W/mK)	0.040														
Compressive stress/strength (kPa)	≥ 100														
Tensile strength perpendicular to board surface (kPa)	≥ 10														
Short-term water absorption (kg/m ²)	≤ 1.0														
Dynamic stiffness (MN/m ³)															
Compressibility (mm)															
Air flow resistivity (kPa·s/m ²)	≥ 100														
Fire reaction ¹⁾	E														

Legend is on page 19; * Product is not currently available. Please contact us for alternative options.

					GUTEX Thermowall NF	GUTEX Thermowall-gf ³⁾									
Tongue and Groove					Tongue and Groove	Tongue and Groove					Butt				
					DIN EN 13171										
80	100	120	140	160	60	40	60	60	60	40	60	40	60	60	
1300 x 600					1800 x 600	1300 x 600	1800 x 600	2576x1176	2600 x 1250	2800 x 1250	3000x1250				
10.00	12.50	15.00	17.50	20.00	10.40	5.80	8.70	12.00	33.60	24.10	36.10	25.90	38.90	41.60	
12.80	16.00	19.20	22.40	25.60	9.60	7.40	11.10	11.10	11.10	7.40	11.10	7.40	11.10	11.10	
56	44	36	32	28	36	108	72	36	18	24	15	24	15	15	
43.68	34.32	28.08	24.96	21.84	38.88	84.24	56.16	38.88	54.52	78.00	48.75	84.00	52.50	56.25	
1275 x 575			1280 x 580		1780 x 580	1275 x 575	1775 x 575	2551x1151							
0.78					1.08	0.78	1.08	3.02	3.25	3.5	3.75				
510	520	510	530	530	370	680	490	680	610	640	730	680	730		
					~ 160	~ 185									
2.00	2.50	3.00	3.50	4.00	1.50	0.90	1.35	1.35	1.35	0.90	1.35	0.90	1.35	1.35	
0.32	0.40	0.48	0.56	0.64	0.24	0.12	0.18	0.18	0.18	0.12	0.18	0.12	0.18	0.18	
					4	3									
					2100	2100									
					0.040	0.043									
					≥ 100	≥ 150									
					≥ 10	≥ 20									
					≤ 1.0	≤ 1.0									
					≥ 100	≥ 100									
					E	E									

Product	GUTEX Thermowall-L ⁴⁾					GUTEX Thermowall Durio
Joint Type	Butt					Nut und Feder
	DIN EN 13171					DIN EN 13171
Thickness (mm)	120	140	160	180	200	70
Length x width (mm)	1250 x 590					1800 x 600
Weight per sheet (kg)	9.70	11.40	13.00	14.60	16.20	12.10
Weight per m ² (kg)	13.20	15.40	17.60	19.80	22.00	11.20
Boards per pallet	36	32	28	24	22	32
Square metres per pallet (m ²)	26.55	23.6	20.65	17.7	16.22	34.56
Actual coverage, length x width (mm)						1780 x 580
Square metres per sheet (m ²)	0.73					1.08
Weight per pallet (kg)	390					380
Density (kg/m ³)	~ 110					~ 160
Nominal thermal resistivity R _D (m ² K/W)	3.15	3.65	4.2	4.7	5.25	1.75
sd-value (m)	0.36	0.42	0.48	0.54	0.60	0.28
Vapour diffusion factor μ	3					4
Specific heat capacity (J/kgK)	2100					2100
Nominal thermal conductivity λ _D (W/mK)	0.038					0.040
Compressive stress/strength (kPa)	≥ 50					≥ 100
Tensile strength perpendicular to board surface (kPa)	≥ 7.5					≥ 10
Short-term water absorption (kg/m ²)	≤ 1.0					≤ 1.0
Dynamic stiffness (MN/m ³)						
Compressibility (mm)						
Air flow resistivity (kPa·s/m ²)	≥ 100					≥ 100
Fire reaction ¹⁾	E					E

Legend is on page 19; * Product is not currently available. Please contact us for alternative options.



- › The thermal resistivity is based on $\lambda_{90/90}$ and board thickness
- › GUTEX Multiplex-top and GUTEX Ultratherm: Guaranteed by Germany's Association of Roofers
- › GUTEX will be glad to send you test reports

¹⁾ Euro class as per DIN EN 13501-1

²⁾ Other dimensions available by request

³⁾ Suitable for REI 90 compliance-tested structures.

⁴⁾ Certification pending

⁵⁾ Custom sizes are available; consult factory or sales agent
Non-smouldering PB-Hoch-180895 as per EN 16733



GUTEX ADVANTAGES



Pleasant indoor climate



Ideal acoustic insulation



Insulation in summer



Insulation in winter



Systems deliver greater dependability



Sustainability



Service

Certified quality

All GUTEX products are manufactured from fir and spruce obtained solely from the Black Forest using sustainable forestry practices – truly the best basis for high quality wood fibre insulation. In addition, the natureplus® certificate indicates the product is biologically safe and manufactured using environmentally safe techniques and practices. It also verifies its suitability and usability for the specified applications.



OUR PRODUCT AND SERVICE DESIGNATIONS



Roof



Wall



Interior

Your source for assistance
with GUTEX products:



GUTEX Holzfaserplattenwerk

Gutenberg 5 | 79761 Waldshut-Tiengen | Germany

Phone: + 49 7741 6099-0 | www.gutex.de | info@gutex.de

Knowing you've
done the right thing.
That's the
GUTEX effect.



THE
GUTEX
EFFECT

All rights reserved. The information provided herein is subject to change. Although all of the information was current at the time of its publication, the publication of superseding information renders the old information invalid. HenseImann GmbH + Co KG is not liable for any damage resulting from error or misprinting. The suitability of the products for applications not specified in this brochure is not guaranteed. Warranty and liability claims are subject to the terms of GUTEX's General Terms of Business.

GUTEX: trendobjects, Dirima, 10/2016. Acknowledgements - Photo Credits: © GUTEX, trendobjects, Dirima, RyszardStelmachowicz, Marco Klaue, Kara/Fotolia

Last updated
03/2023